

Compact Classic Air, Installation/Operation manual

Safety

For your own and others safety, please read this first.

If a battery charger is mounted, it must be connected to the battery, never direct to the refrigeration unit.

Never open the refrigerant circuit, except by the quick couplings, they are of self-sealing type and designed for this purpose.

The refrigeration unit must be disposed by a certified refrigeration specialist for correct recycling of components and care taking of the refrigerant.

Make sure the compressor ventilation is not blocked.

Mounting evaporator

Place the evaporator high in the box, the flat evaporator on one, or after bending, more vertical walls. Place the O-evaporator either horizontal or vertical, use the distances when mounting.

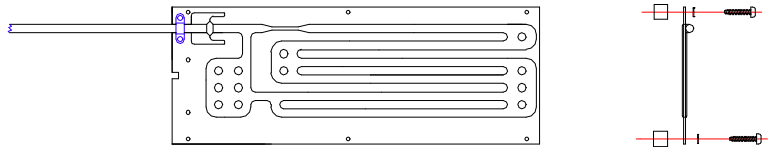

Drill a \varnothing 30 mm / 1 1/4" hole in the wall (upper corner) for passage of the connection pipe with couplings.

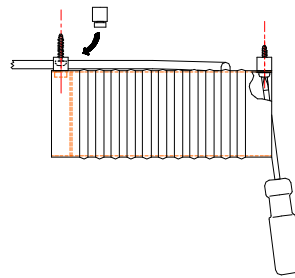

Mounting thermostat

Place the thermostat sensor end for metallic contact with the evaporator, either with the screw-bracket in the pre-drilled holes or with the clip on the edge of the evaporator. On bigger flat evaporators, mounting the clip on the upper edge compared to the lower edge, means a temperature difference of up to 5°C/9°F.

Upper edge=colder box temperature with the same thermostat setting.

Place the thermostat housing inside or outside the box.

Connect the cables to the electronic unit, to C and T, colours insignificant.

Models with larger evaporators also have a resistor on the cable at the T tab, for compressor speed setting.

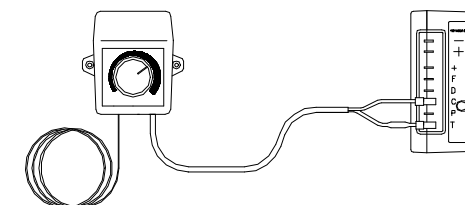
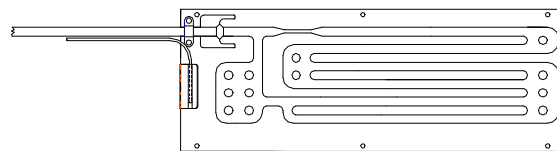
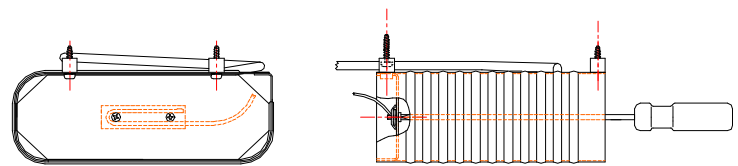

Mounting Compressor

The compressor shall be mounted horizontally, fasten the rubber feet with the holding brackets. Screw them well against the mounting surface.

Connect the quick-couplings to the compressor unit. Connect first the thin capillary tube. Rotate the female coupling nut only. The male coupling must be held stationary to avoid damage on the thin tube. Tighten couplings to the bottom, tighten finally, reasonably firm, using fixed spanners 21 and 24 mm.

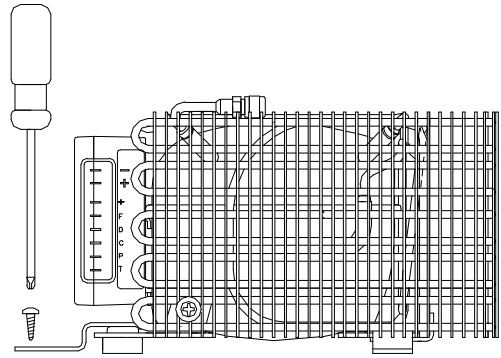

Electrical connection

Connect battery + to the + tab on the electronic unit using the 15A fuse in between. (24 volt/7.5A)

Connect the battery - to the - tab on the electronic unit.

Use cable sizes as follows (12 volt):

Max cable length 2.5 m: 2.5 mm². 4 m: 4 mm²,
6 m: 6mm², etc.

Max 8 ft.: Gauge 12, 19 ft.: Gauge 10, 33 ft.: Gauge 8

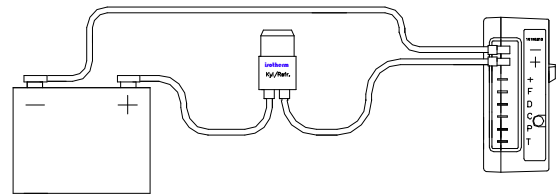

Ventilation

Good ventilation for the compressor compartment must be arranged. Make openings low and high in the compartment, to allow cold air to come in from below and warm air to leave upwards. Openings having an area of 70-75 cm² / 10-11 sq. inch each, is recommended.

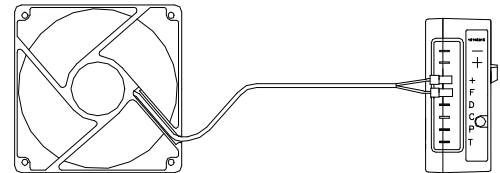

Operation

Start by turning the knob to clockwise, warmest setting just after turning on and coldest at its maximum position clockwise.

Shut off by turning thermostat knob max. anti-clockwise. A certain spring resistances shall be passed.

Shut off and de-frost when the frost layer on the evaporator is more than 3-5 mm / 1/8" - 1/4" thick.

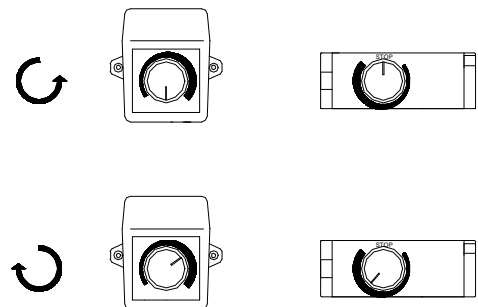

Technical data

Voltage: 12/24 volt

Power consumption 2.5 - 6A (depending on model)

Average consumption: 0.6 - 1.2A (depending on model)

Compressor: Danfoss BD35F or BD50F (depending on model)

Capacity: Top loaded fridge boxes 60 to 400 litres (depending on model)

Fuse: 15A - 12V / 7.5A - 24V

Battery protection: Cut-out at 10.4 volt, cut-in at 11.7 volt

Fulfills EMC directives, CE-marked



IT-61019 S. Agata Feltria (PU) - Italy

Tel +39 0541 848030

Fax +39 0541 848563

Info@indelmarine.com

www.indelmarine.com